

Company Name: \_\_\_\_\_

Phone#: \_\_\_\_\_

Contact Name: \_\_\_\_\_

Fax#: \_\_\_\_\_

E-mail Address: \_\_\_\_\_

P.O.#: \_\_\_\_\_

Ship To Address: \_\_\_\_\_

Method of Shipment: (please mark one)  UPS Next Day Air  UPS 2<sup>nd</sup> Day Air  UPS 3-Day  UPS Ground

## **Spirit 400 Amp** **Consumable Order Form**

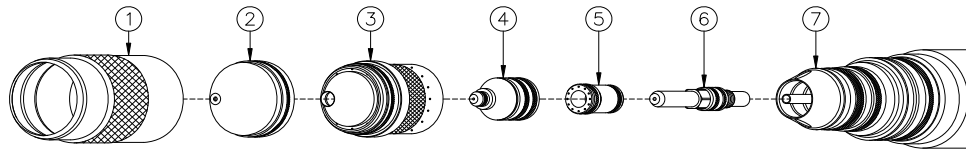

<u>Item #</u>	<u>Part #</u>	<u>Description</u>	<u>Quantity</u>
1	284150	Outer Retaining Cap	_____
2	277115	Shield Cap	_____
2	277117	Shield Cap	_____
2	277144	Shield Cap	_____
2	277145	Shield Cap	_____
2	277146	Shield Cap	_____
2	277149	Shield Cap	_____
2	277150	Shield Cap	_____
2	277211	Shield Cap	_____
2	277263	Shield Cap	_____
2	277274	Shield Cap	_____
2	277286	Shield Cap	_____
2	277298	Shield Cap	_____
2	284123	Shield Cap	_____
2	284155	Shield Cap	_____
3	277110	Inner Retaining Cap	_____
3	277113	Inner Retaining Cap	_____
3	277151	Inner Retaining Cap	_____
3	277152	Inner Retaining Cap	_____
3	277153	Inner Retaining Cap	_____

Spirit 400 Consumable Order Form

3	277266	Inner Retaining Cap	_____
3	277280	Inner Retaining Cap	_____
3	284121	Inner Retaining Cap	_____
3	284156	Inner Retaining Cap	_____
4	277118	Nozzle	_____
4	277120	Nozzle	_____
4	277121	Nozzle	_____
4	277122	Nozzle	_____
4	277123	Nozzle	_____
4	277124	Nozzle	_____
4	277125	Nozzle	_____
4	277126	Nozzle	_____
4	277269	Nozzle	_____
4	277276	Nozzle	_____
4	277284	Nozzle	_____
4	277287	Nozzle	_____
4	277289	Nozzle	_____
4	277293	Nozzle	_____
4	277297	Nozzle	_____
4	284125	Nozzle	_____
4	284157	Nozzle	_____
4	284158	Nozzle	_____
5	277138	Swirl Ring	_____
5	277139	Swirl Ring	_____
5	277140	Swirl Ring	_____
5	277141	Swirl Ring	_____
5	277142	Swirl Ring	_____
5	277143	Swirl Ring	_____
5	277258	Swirl Ring	_____
5	277259	Swirl Ring	_____
5	277283	Swirl Ring	_____

Spirit 400 Consumable Order Form

5	284122	Swirl Ring	_____
6	277130	Endura™ Electrode	_____
6	277131	Endura™ Electrode	_____
6	277132	Endura™ Electrode	_____
6	277133	Endura™ Electrode	_____
6	277135	Endura™ Electrode	_____
6	277137	Endura™ Electrode	_____
6	277190	Endura™ Electrode	_____
6	277270	Endura™ Electrode	_____
6	277282	Endura™ Electrode	_____
6	277291	Endura™ Electrode	_____
6	277292	Endura™ Electrode	_____
6	284124	Endura™ Electrode	_____
6	284159	Endura™ Electrode	_____
7	278000	Torch Main Body with torch exchange	_____
Not shown	278001	Torch Handle Assembly	_____
Not shown	260105	Swirl Ring Removal Tool	_____
Not shown	277056	Nozzle Removal Tool	_____
Not shown	277086	Electrode Removal Tool Driver	_____
Not shown	277087	Electrode Removal Tool Socket (30-275A)	_____
Not shown	284052	Electrode Removal Tool Socket (400A)	_____
Not shown	500018	Torch O-Ring ( <b>Red-upper</b> – seals IRC)	_____
Not shown	500024	Torch O-Ring ( <b>Blue-lower</b> – seals IRC)	_____
Not shown	820209	Torch O-Ring ( <b>Black/Red</b> – seals ORC)	_____
Not shown	716012	O-Ring Lubricant - Oxygen Compatible	_____
Not shown	500695	Coolant – 1 gallon	_____

Phone#800-252-2850

Fax#843-795-8931

[customer.service@kaliburn.net](mailto:customer.service@kaliburn.net)

Remittance: PO Box 12639, Charleston, SC 29422-2639

Shipping: 455-D Fleming Rd, Charleston, SC 29412



February 2008